

APPLICATION FOR CERTIFICATE OF APPROPRIATENESS (COA)

Building address 401 S 4th Street, Bethlehem, PA 18015

Owner of building FAZA Sharmuham Phone [REDACTED]

Owner's **email** & mailing address [REDACTED]

Applicant Kalca Sharmuham Phone [REDACTED]

Applicant's **email** & mailing address [REDACTED]

Street and Number

City

State

Zip Code

VA2016

APPLICANT MUST ATTEND MEETING FOR CASE TO BE HEARD.

USE THE CHECKLIST ON THE BACK OF THIS APPLICATION TO ENSURE YOUR SUBMISSION IS COMPLETE.

Historic & Architectural Review Board – Application form, photographs, and drawings must be submitted 2 weeks prior to the regular scheduled meeting in order to be placed on the agenda for the next meeting.

South Bethlehem & Mount Airy Historic Conservation Commission - Application form, photographs, and drawings must be submitted 2 weeks prior to the regular scheduled meeting in order to be placed on the agenda for the next meeting.

1. PHOTOGRAPHS - Photographs of your building and neighboring buildings **must accompany** your application.

2. TYPE OF WORK PROPOSED – Check all that apply. Please bring any samples or manufactures specifications for products you will use in this project.

- Trim and decorative woodwork
- Siding and Masonry
- Roofing, gutter and downspout
- Windows, doors, and associated hardware
- Storm windows and storm doors
- Shutters and associated hardware
- Paint (Submit color chips – HARB only)
- Skylights
- Metal work
- Light fixtures
- Signs
- Demolition
- Other Terrace Repair

3. DRAWINGS OF PROPOSED WORK – Required drawings **must accompany** your application. Please submit **ONE ORIGINAL AND TEN (10) COPIES OF DRAWINGS, PHOTOGRAPHS, APPLICATION FORM, AND ANY SPECIFICATIONS**

- Alteration, renovation, restoration (1/4 or 1/8"=1'0" scale drawings required IF walls or openings altered.)
- New addition (1/4" or 1/8"=1'0" scale drawings: elevations, floor plans, site plan)
- New building or structure (1/4" or 1/8"=1'0" scale drawings: elevations, floor plans, site plan)
- Demolition, removal of building features or building (1/4" or 1/8"=1'0" scale drawings: elevation of remaining site and site plan)
- A scale drawing, with an elevation view, is required for all sign submittals

4. DESCRIBE PROJECT – Describe any work checked in #2 and #3 above. Attach additional sheets as needed.

5. APPLICANT'S SIGNATURE _____ **DATE:** _____

Garage Roof Repair

Proposal 2

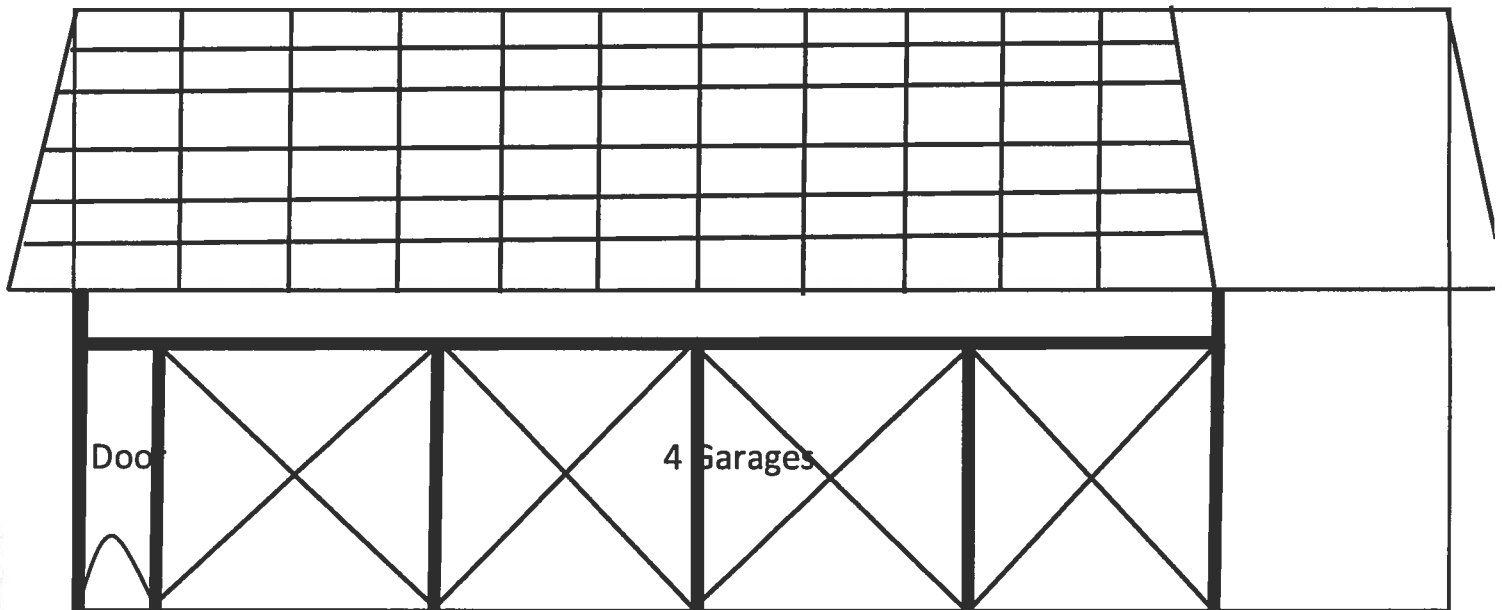

Proposed work 1:

1. Demolish the existing flat roof as the part of the roof was fallen down due to the tenant pulling the garage door down, which is attached to the roof beam.
2. Cement the entire brick wall both inside and outside and fix the wall.
3. Remove the garage door and keep it open.
4. Install weather proof beams to support the walls in between the garages both on top and inside

Proposed work 2:

1. Demolish the existing flat roof as the part of the roof was fallen down due to the tenant pulling the garage door down, which is attached to the roof beam.
2. Cement the entire brick wall both inside and outside and fix the wall.
3. Remove the garage door and keep it open.
4. Replace the damaged wood and put new flat roof

Proposal 1

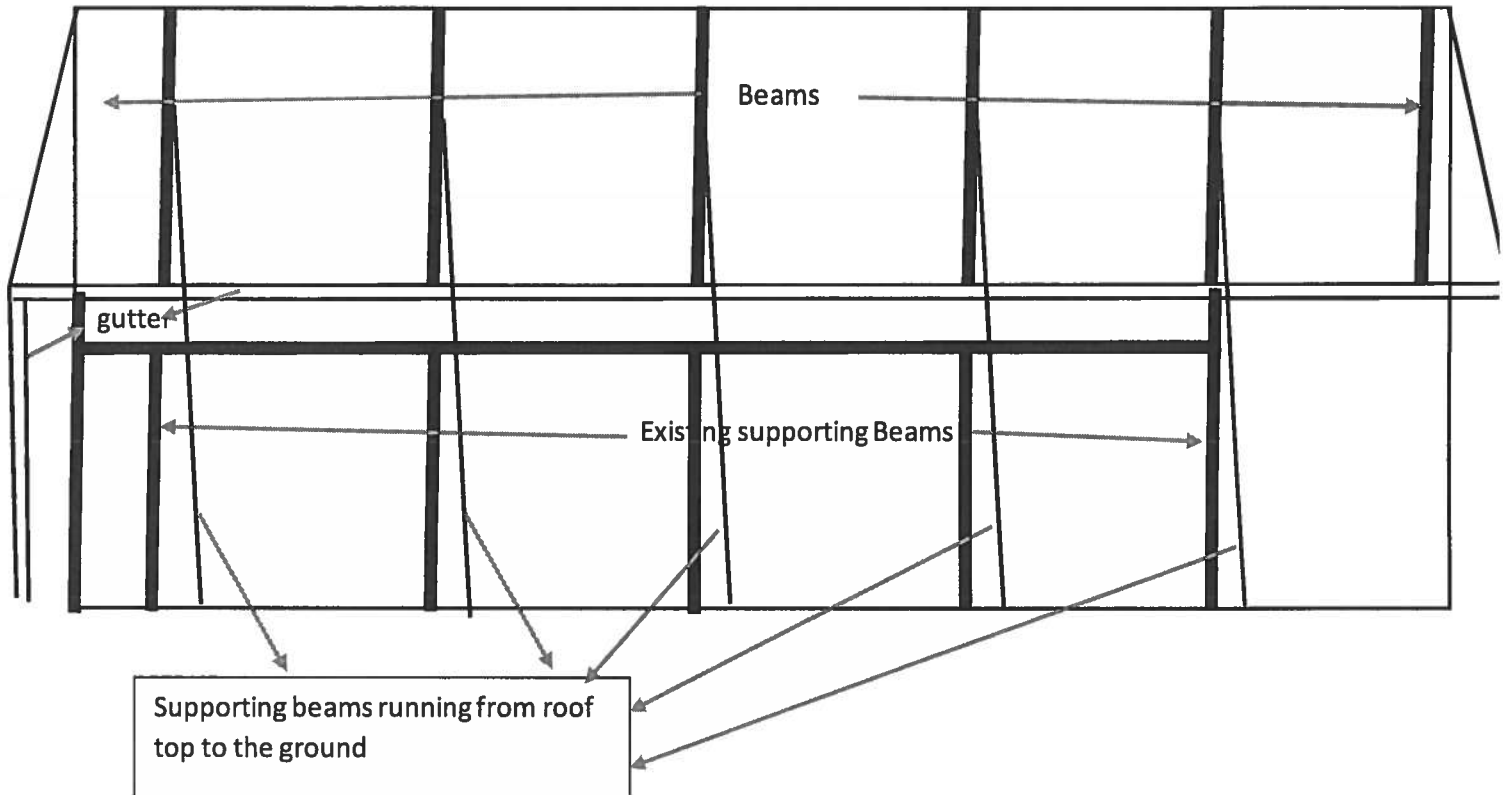

Terrace Repair:

1. Trim and decorate wood work on the Terrace. Replace the circle wood that goes around terrace at the bottom.
2. Fix the circle at the bottom.
3. Repair the right side of the circle wood at the first floor.
4. Replace the existing window with new straight windows
5. Photos attached.

